

REV.	DESCRIPTION	DATE	BY

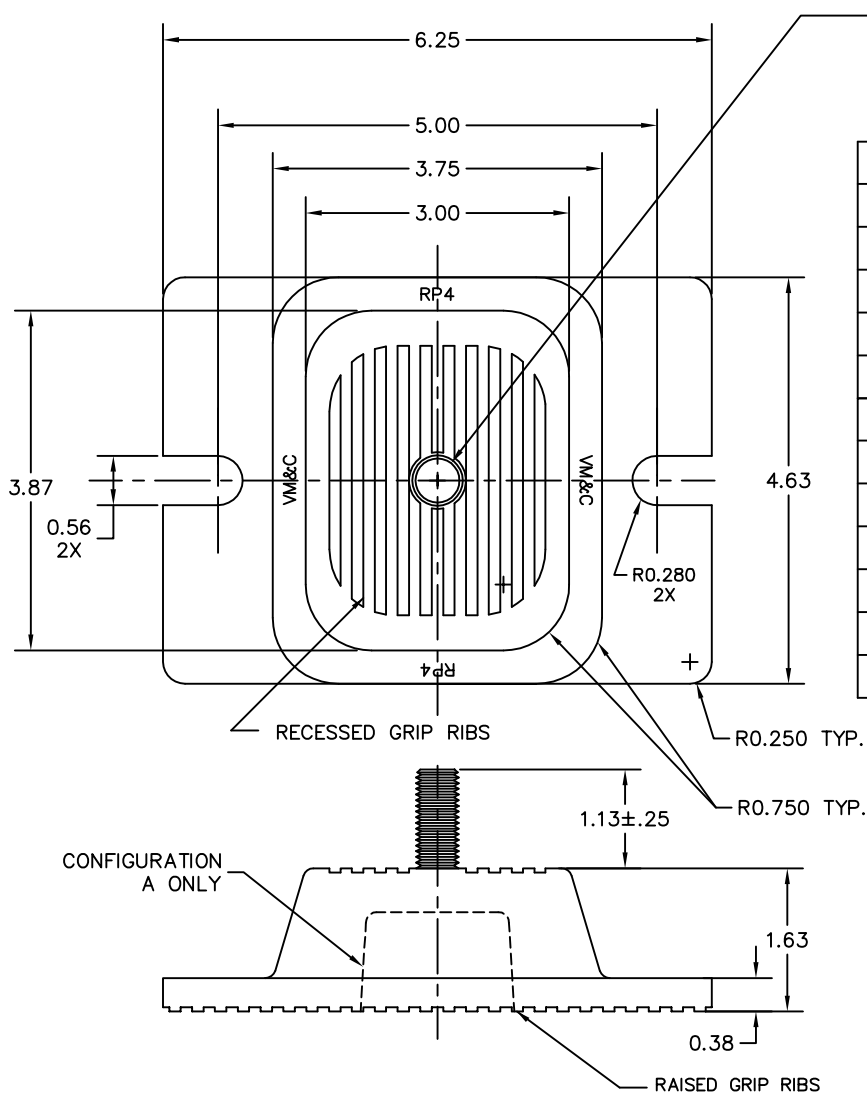

TABLE 1

PART NUMBER	MODEL	RATED AXIAL LOAD-LBS	CONFIG.	DEFLECTION AT RATED LOAD-INCHES
114A-100417-01	RP4-BLUE-WR-A	△	A	△
114A-100417-02	RP4-BROWN-WR-A	1500	A	0.25
114A-100417-03	RP4-RED-WR-A	2250	A	0.25
114A-100417-04	RP4-GREEN-WR-A	3000	A	0.25
114A-100417-05	RP4-GRAY-WR-A	4000	A	0.25
114A-100417-06	RP4-PURPLE-WR-A	△	A	△
114A-100417-07	RP4-BLUE-WR-B	△	B	0.25
114A-100417-08	RP4-BROWN-WR-B	1500	B	0.25
114A-100417-09	RP4-RED-WR-B	2250	B	0.25
114A-100417-10	RP4-GREEN-WR-B	3000	B	0.25
114A-100417-11	RP4-GRAY-WR-B	4000	B	0.25
114A-100417-12	RP4-PURPLE-WR-B	△	B	0.25

- NOTES:
1. DIMENSIONS FOR CUSTOMER REFERENCE.
  2. TABLE 1 IS AVERAGE DESIGN DATA FOR REFERENCE.
  3. MOLDED STEEL AND ELASTOMER MOUNT FOR NON-FAIL SAFE, OUTDOOR SERVICE CONDITIONS.
  4. CONSULT VMC FOR APPLICABILITY.
- △ CONTACT VMC FOR APPLICABLE RATED LOAD AND DEFLECTION.

OTHER MATERIALS, COMPOUNDS, OR FINISHES WITH EQUAL OR SUPERIOR PROPERTIES MAY BE SUBSTITUTED AS THEY BECOME AVAILABLE.

**CERTIFIED FOR:**

JOB NAME: \_\_\_\_\_  
 CUSTOMER : \_\_\_\_\_  
 CUSTOMER P.O.: \_\_\_\_\_  
 SALES ORDER: \_\_\_\_\_

**MODEL RP4 1500-4000 LBS.  
 DURULENE ELASTOMERIC ISOLATOR  
 WITH POSITIONING PIN  
 0.25 INCH DEFLECTION**



**THE VMC GROUP**  
*The Power of Together*  
 Bloomingdale, NJ 07403  
 Houston, TX 77041

SCALE :

NONE

SHEET:



DRAWING NO.:

REVISION